

## Installation and maintenance instructions

### Standard door case

Status 06/2013

#### Usable for:

- Single-leaf doors
- Rebated
- Special architrave width
- Noise protection
- Damp room
- Double-leaf doors
- Flush
- Continuous door case
- Heat insulation



## Installation and maintenance instructions

### Standard door case

Status 06/2013

**These installation instructions are to be read in their entirety before the installation of the element and must be handed over to the end customer afterwards.**

#### Please observe before the installation:

- The finished door case is matched to ready-to-hang door leaves with dimensions conforming to DIN 18101 and to the dimensions in the unfinished state according to DIN 18100.
- Check that the goods supplied are complete and undamaged.
  - **Caution:** after the installation we can no longer provide a replacement.
- The installation of the door elements should take place only during the final stage of the interior fittings.
  - Wall opening tolerances in the building must be checked and adjusted if necessary.
- The relative humidity at the place of installation may not exceed 60 % at a temperature of approx. +15 °C to +20 °C. If the climate is permanently over the limit mentioned, the installation should not be carried out due to the expected negative effects on the door element.

- **The hinge side (DIN direction) of the door element is to be observed!**



#### Scope of supply



Standard door case

- 3 door case parts (2 jambs, 1 head)
- 3 decorative architrave parts (2 jambs, 1 head)
- 1 bag of fittings
- Installation instructions

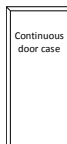

Continuous door case

- 3 door case parts (2 jambs, 1 head)
- 6 decorative architrave parts (4 jambs, 2 head)
- 1 bag of fittings
- Installation instructions

#### Required tools:

- Flat-blade screwdriver
- Crosshead screwdriver
- T-handle Allen key - size 4
- Hammer
- Spirit level (long and short)
- Wedges / reinforcements
- PVAC glue (white glue)
- Door case spreaders/clamps
- Mounting foam
- Silicone if necessary
- Drill / cordless screwdriver if necessary

#### Functional elements

**In case of noise insulating, damp room and thermally insulating elements, the following must be observed in addition:**

##### Before the installation:

- Attach a closed-cell installation tape to the rear of the decorative and rebate architraves (wall side).

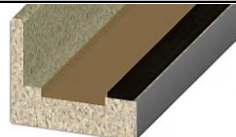

##### After the installation:

- Fill all hollow spaces between the door case and wall opening completely with mineral wool or filling foam (2-component PU foam), especially in the area of the sealing level.
- Seal the architrave to the wall with a permanently elastic seal. Make sure that no open joints remain all round!
- If present, the floor seal can be adjusted in height by turning the release pin (hinge side). The sealing profile is to be shortened to match the clearance rebate size of the door case. In case of carpet or rough floor surfaces, use a rail, which is to be sealed to the floor with a permanently elastic seal.

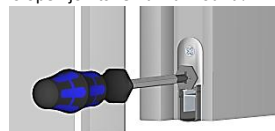

## Installation and maintenance instructions

### Standard door case

Status 06/2013

#### 1 Assembly of the door case / decorative architrave



- Place the door case parts and the decorative architrave on a clean and even surface.
- **Note:** spread cardboard (or similar) over the floor in order to avoid surface scratches. (optional: assembly trestles - order number 0000014478)
- In case of **continuous door cases:** Pull the inserted decorative architraves carefully out of the case board.

#### 2 Assembly of the case / decorative architrave - glue specification / biscuit joiner spring

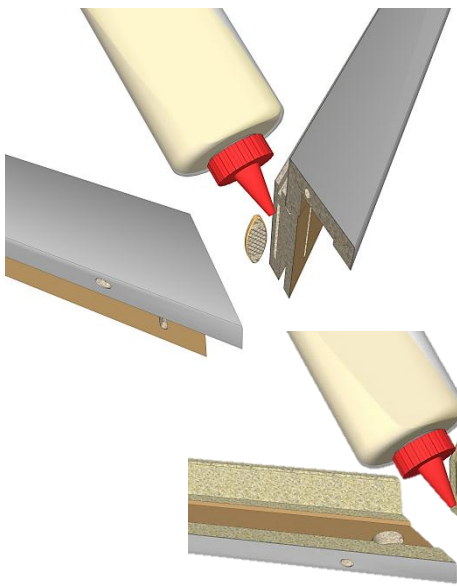

- In order to obtain a clean joint when joining the case parts, the seals in the area of the mitres are to be pulled out of the grooves.
- In the case of **EC /RF** cases, the mitre links can already be inserted into the holes provided at this point for easier handling (see point **3a**)
- Apply glue in the grooves of the biscuit joiners and on the mitre surfaces of the door case parts and then insert the biscuit joiners.
- In case of **continuous door cases**, a decorative architrave is to be attached in advance (see points 2-3)
- Determine the correct insertion depth of the decorative architrave on the basis of the existing wall thickness. Then glue one side of the assembled decorative architrave at the corresponding depth in the case board.
- Wipe off surplus glue immediately. Observe the drying time of the glue before further processing!
- The remaining steps are identical to the standard case.

#### 3a Assembly case / decorative architrave - mitre connection for door case EC/RF

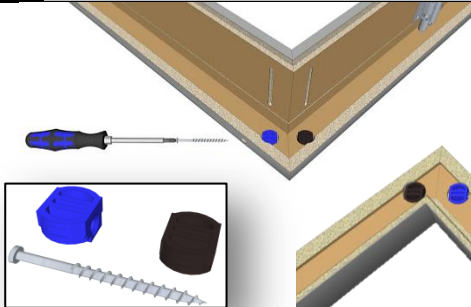

- Insert the mitre connectors (blue = head and black = jamb) into the pre-drilled holes, parallel to the screw hole.
- Join the door case parts together
- Align the mitres flush.
- Insert the screw from the head and tighten very carefully with a crosshead screwdriver. (not with a cordless screwdriver)

## Installation and maintenance instructions

### Standard door case

Status 06/2013

#### 3b Assembly of case / decorative architrave - mitre connection for door case PR / SLF / 80/22

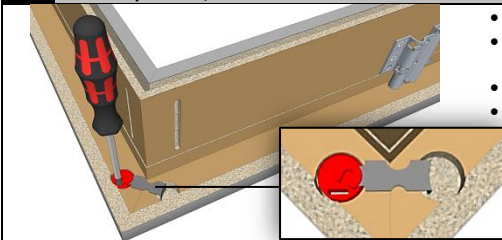

- Join the door case parts together
- Insert eccentric connectors (red) into the pre-drilled holes.
- Align the mitres flush.
- Fasten the eccentrics by turning the red plastic part in a clockwise direction with a flat-blade screwdriver (not with a cordless screwdriver).

#### 3c Assembly of case / decorative architrave - mitre connection for architrave width from 90 mm

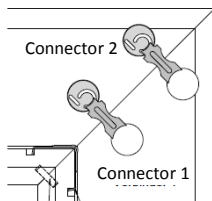

- **Architrave width from 90 mm**
- Join the door case parts together
- Insert 2 eccentric connectors (red) into the pre-drilled holes.
- Align the mitres flush.
- First fasten connector 1 in a clockwise direction with a flat-blade screwdriver.
- Then check the alignment of the mitres again and fasten connector 2.

#### 4 Assembly of case / decorative architrave - corner connection clips

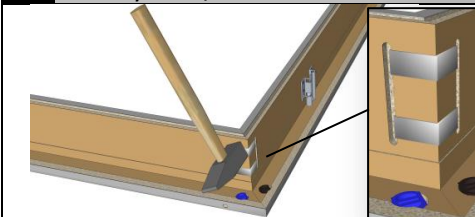

- Place the steel clips in the slots in the head and tap into the slots in the jamb with the aid of a hammer.
- Wipe off surplus glue immediately.
- Observe the drying time of the glue before further processing!

#### A Door case installation

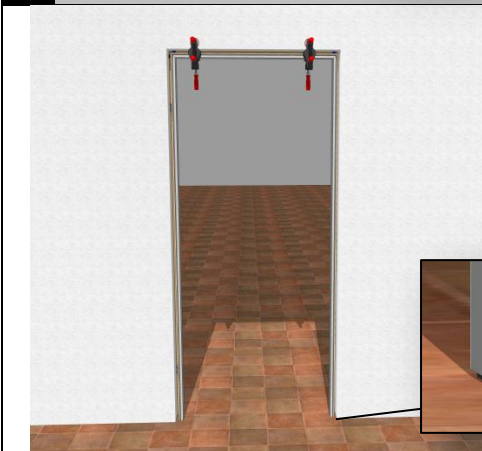

- Carefully insert the assembled door case into the wall opening.
- In order to avoid damage to the door case due to the effects of moisture (e.g. by cleaning water), the door case must be shimmed (2 - 3 mm) in the area of the floor joint and sealed with a permanently elastic seal after completion of the installation.
- To fix, place door case clamps (alternatively wedges or air cushions) on the upper case board.

**Shim**

## Installation and maintenance instructions

### Standard door case

Status 06/2013

#### B Door case installation



- Subsequently, align the door case vertically and horizontally.
- Insert firm backing between case and wall in the hinge and lock area and place door case spreaders in position.
- If existent, remove the transport protection under the door leaf before hanging the door leaf, aligning and checking the function. If necessary the frame must be shortened or shimmed when installing.
- Moreover, the lower air gap can be adjusted by adapting or shortening the door leaf (necessary, for example, if there is great unevenness of the floor).
- The door case rebate dimension must be centred (3.5 mm on each side). In the case of the flush execution this must be done absolutely parallel.
- **Caution:** before closing the door leaf, the key must be removed from the lock together with the transport lock in order to avoid damage.
- Keep a building site handle to hand on handle before closing the door leaf.

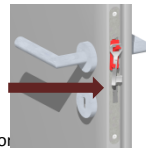

#### C Door element adjustment options

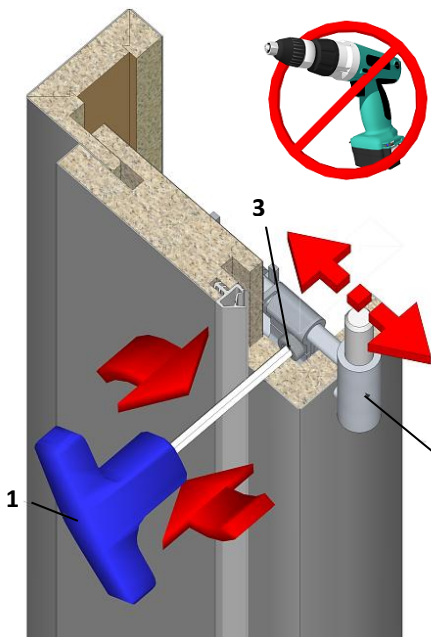

**Caution:** the hinge fixing screw is not tight in the delivery condition!

##### Door leaf adjustment options:

- By screwing the hinges in or out, the door leaf can be adjusted laterally in order to achieve the desired rebate size.



##### Adjustment options for rebated case:

- The frame part of the hinge (2) is released with the fixing screws (3) of the hinge pockets.
- Now shift this until the door leaf lies flat against the door case in the closed state. However, it should be possible to close the door leaf without any great resistance.
- Do not forget to tighten the screw (3) afterwards with a suitable T-handle Allen key, size 4 (1). (Tighten to 7 Nm)
- **The screw (3) must not be tightened with a cordless screwdriver or a ratchet! Risk of overturning!!!**
- The screw openings can be sealed with the caps provided in the bag of fittings.

##### Adjustment options for flush case:

- In the case of flush elements the rebate gap must be adjusted evenly and parallel to the door leaf.
- To adjust the hinges, follow the adjustment instructions provided with the hinge.

## Installation and maintenance instructions

### Standard door case

Status 06/2013

#### D Door case installation - door leaves up to a weight of approx. 30 kg

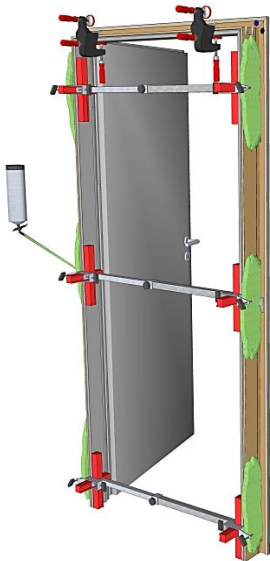

- Before foaming, check the frame rebate dimension again at the heights of the door case spreaders.
- The places to be foamed must be free of dust and grease.
- **Note:** in the case of stud constructions with plaster boarding the adhesion of the mounting foam can be very limited on the sheet steel uprights and cut edges of the wall boarding. Therefore some extra layers should be screwed into the wall reveal to which the foam can adhere well later on.
- Foam is now injected into the space between the door case and the wall over the entire thickness of the wall.  
(On both sides next to the door case spreaders)
  - On account of the swelling behaviour we expressly recommend the use of a 2-components PU frame foam.
- The foam manufacturer's instructions are to be observed with regard to the use and hardening time of the foam.

#### E Door case installation - recommendation: door leaves from a weight of approx. 30 kg

##### Fastening points

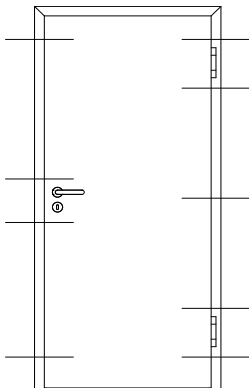

Heavy door elements (from a weight of approx. 30 kg) are to be constructively (mechanically) attached to the wall.

Only in this way can sinking be permanently avoided.

- To do this, insert firm backing between the door case and wall (to the thickness of the air gap) before foaming.
- **The screw connection should take place through the door case rebate only after the foaming of the door case.**
- First of all remove the door case seal at the side.
- Drill fixing holes through the door case rebate and backing ( $\varnothing$  8 mm).  
(optional: drilling template for case fastening order no. 0000006699)
- Subsequently the door case is screwed to the wall (e.g. spacer screws + rawlplugs)  
Bag of fittings: order no. 0000539418

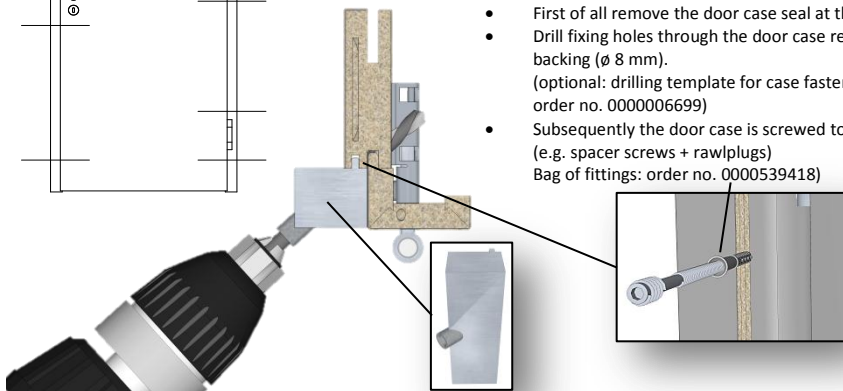

- Now insert the door case seal again.



## Installation and maintenance instructions

### Standard door case

Status 06/2013

#### F Inserting the decorative architrave



- Once the foam has fully hardened, remove the door case spreaders and the wedges.
- Cut off any surplus foam.
- Insert spots of white glue in the longitudinal and transverse slots for the fastening of the decorative architrave to the rear side of the door case.
- In order to avoid damage to the upper corners of the frame, press the decorative architrave in from the top downwards.
  - The adjustable decorative architrave compensates tolerances ( $\pm 10$  mm) in the wall thickness here.

#### G Floor joint



- After completion of the installation, if the floor is smooth, the floor joint must be sealed against the effects of moisture (e.g. cleaning water) with a permanently elastic sealant (e.g. silicone). The manufacturer's data are to be observed regarding drying times.

#### H Adjustment of the striker plate



• **Rebated:** the striker plate is provided with filing lugs which can be trued up if necessary. **Caution !** before possibly reworking the closing plate due to difficulties in closing the door, the sealing pressure is to be normalised by holding the door closed !

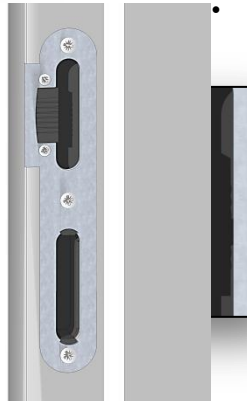

- **Flush:** the striker plate is provided with a noise-reducing plastic lockjaw that can be adjusted after loosening the two screws.

## Installation and maintenance instructions

### Standard door case

Status 06/2013

#### Other information

- No legal claims can be derived from these installation instructions. The method of installation described here is only a recommendation for the installation of the door elements.
- Care should be taken when installing the door case that a later replacement is possible without destroying facing plaster (wallpaper or similar).
- Due to the increased hygrothermic loads in wet cells (bathrooms and WCs), we generally recommend that you seal the bottom edge of the door leaf watertight (e.g. by painting). If the surface is exposed to condensed water or briefly to splash-water, a damp room element must be installed.
- **Possibility to shorten the door leaves:**
  - Inner layers honeycomb and RST can be shortened by 20 mm.
  - Inner layers VS and RS can be shortened by 50 mm.
  - Door leaves with existing floor seal can be shortened by 20 mm.  
The slot of the floor seal must be re-milled accordingly if necessary.
  - **The respective assembly instructions for the functional door element apply to functional doors.**
- The holes for the door handle set must be drilled on both sides from each side of the door leaf. Drilling through the lock is impermissible. To avoid damage to the lock and malfunctions, it must be removed first. The rosette and the key plates of the door handle set must be carefully screwed tight by hand. Overtightening can lead to the formation of cracks. This is very frequently the case when using cordless screwdrivers and leads to impairment of the function of the lock and handle.
- If mounting foam comes into contact with the door elements they will be affected and can no longer be reworked.
- When masking door elements with tape (e.g. for protection when painting), make sure that a masking tape is used that does not affect or etch the surface. The masking tape must be removed immediately after completion of the work (observe the manufacturer's instructions).
- In the case of doors with glued-on sash bar frames, care must be taken that water does not penetrate into the sash hinge, since this negatively affects the adhesion of the hinge.
- Glazing: in the case of doors with glazing, it is the glazier's duty to inform the end customer of the type of glazing installed (e.g. float glass, tempered safety glass etc.). Safety glass is to be used in danger areas.
- For glazing we refer you to the corresponding glazing instructions.
- When setting a door stopper for the limitation of the door opening angle, care must be taken that this is placed as far away from the hinge axis as possible, otherwise the lever forces will inevitably lead to damage to the door frame and the hinge suspension. We recommend that the door stopper be placed in the final third of the door width on the lock side.

#### Service instructions

- All parts are to be submitted to maintenance at least once a year. The intervals must be shortened in case of a high frequency of use (half-yearly or quarterly).
- All moving fittings such as hinges, lock and release traps of the floor seal are to be greased (for the first time during the installation) unless they have been declared as maintenance-free. While doing so the fittings are also to be checked for tightness and wear. If necessary, retighten fixing screws or replace defective fittings.
- Furthermore, ensure that all seals are seated correctly. Damaged seals must be replaced immediately.
- The floor seal is to be adjusted to that the seal rests tight against the floor along its entire length.
- The door closer (if existent) are to be maintained in accordance with the manufacturer's instructions and adjusted if necessary, so that the self-closing property of the door element is ensured at all times.

#### Care instructions

- All surfaces are easy to care for and can be kept clean by wiping with a clean cloth. **Caution !** Micro fibre or cleaning fibre cloths may not be used !
- The use of scouring and aggressive cleaning agents is to be avoided.
- In case of heavy soiling there is a special alcohol cleaner that is suitable for the surface and rubber seal.